

FEMALE INSULATED DISCONNECTORS

Lead section: $0.5\sim 1.5\text{mm}^2$ (22~16) max current=10A



ITEM NO.	Neme tab (mm)	Thickness (mm)	Dimension				
			B (mm)	d φ (mm)	D φ (mm)	L (mm)	H (mm)
FDD1.25-110(5)	0.5×2.8	0.3	3.8	1.70	3.80	19.0	10.0
FDD1.25-110(8)	0.8×2.8	0.3	3.8	1.70	3.80	19.0	
FDD1.25-187(5)	0.5×4.75	0.35	5.6	1.70	3.80	19.0	
FDD1.25-187(8)	0.8×4.75	0.35	5.6	1.70	3.80	19.0	
FDD1.25-205	1.5×5.2	0.35	6.5	1.70	3.80	20.0	
FDD1.25-250	0.8×6.35	0.4	7.4	1.70	3.80	21.0	

Lead section: $1.5\sim 2.5\text{mm}^2$ (16~14) max current=15A

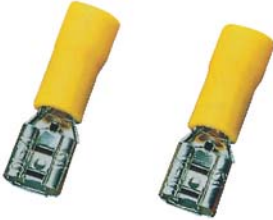

ITEM NO.	Neme tab (mm)	Thickness (mm)	Dimension				
			B (mm)	d φ (mm)	D φ (mm)	L (mm)	H (mm)
FDD2-110(5)	0.5×0.8	0.3	3.8	2.3	4.3	19.0	10.0
FDD2-110(8)	0.8×2.8	0.3	3.8	2.3	4.3	19.0	
FDD2-187(5)	0.5×4.75	0.35	5.6	2.3	4.3	19.0	
FDD2-187(8)	0.8×4.75	0.35	5.6	2.3	4.3	19.0	
FDD2-205	0.5×5.2	0.35	6.5	2.3	4.3	20.0	
FDD2-250	0.8×6.35	0.4	7.4	2.3	4.3	21.0	
FDD2-312	0.8×0.8	0.4	9.0	2.3	4.3	23.0	

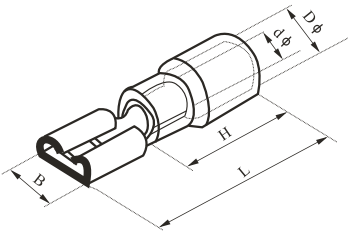

Lead section: $4\sim 6\text{mm}^2$ (12~10) max current=24A

ITEM NO.	Neme tab (mm)	Thickness (mm)	Dimension				
			B (mm)	d φ (mm)	D φ (mm)	L (mm)	H (mm)
FDD5.5-250	0.5×6.35	0.4	7.4	3.4	5.7	25.0	14.0
FDD5.5-375	1.2×9.4	0.5	10.9	3.4	5.7	29.6	

PIN INSULATED TERMINALS

Lead section: $0.5 \sim 1.5 \text{mm}^2$ (22~16) max current=19A



ITEM.NO.	F φ (mm)	Dimension (mm)			Color
		L	H	D φ	
PTV1.25-9	1.9	19.0	10.0	4.3	Red
PTV1.25-10	1.9	20.0			
PTV1.25-12	1.9	22.0			
PTV1.25-13	1.9	23.0			



Lead section: $1.5 \sim 2.5 \text{mm}^2$ (16~14) max current=27A



ITEM.NO.	F φ (mm)	Dimension (mm)			Color
		L	H	D φ	
PTV2-9	1.9	19.0	10.0	4.9	Blue
PTV2-10	1.9	20.0			
PTV2-12	1.9	22.0			
PTV2-13	1.9	23.0			



Lead section: $4 \sim 6 \text{mm}^2$ (12~10) max current=48A

ITEM.NO.	F φ (mm)	Dimension (mm)			Color
		L	H	D φ	
PTV5.5-13	2.8	25.5	12.5	6.7	Yellow

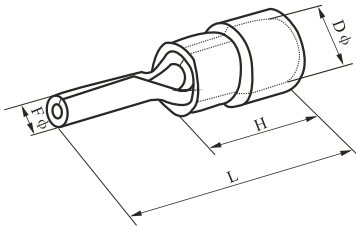

Lead section: $0.5 \sim 1.5 \text{mm}^2$ (22~16) max current=19A

ITEM.NO.	Dimension (mm)			
	W	L	F	C
BDV1.25-10	2.3	20.0	10.0	4.3
BDV1.25-11	3.0	21.0	11.0	
BDV1.25-14	3.0	24.0	14.0	
BDV1.25-18	2.3	28.0	18.0	

Lead section: $1.5 \sim 2.5 \text{mm}^2$ (16~14) max current=19A

ITEM.NO.	Dimension (mm)			
	W	L	F	C
BDV2-9	2.8	19.0	9.0	4.9
BDV2-18	2.3	28.0	18.0	

Lead section: $4 \sim 6 \text{mm}^2$ (12~10) max current=48A

ITEM.NO.	Dimension (mm)			
	W	L	F	C
BDV5.5-10	2.8	22.5	10.0	5.6

SPADE INSULATED TERMINALS

Lead section:0.5~1.5mm²(22~16) Max current:=9A



ITEM.NO.	Number of ANSI bolt	diameter of bolt mouth d2	B (mm)	L (mm)	F (mm)	H (mm)	D φ (mm)	Color
SV1.25-3	#4	3.2MM	5.7	21.2	6.5	10.0	4.3	Red
SV1.25-3.5	#6	3.7MM	5.7	21.2	6.5			
SV1.25-3.5	#6	3.7MM	6.4	21.2	6.5			
SV1.25-4	#8	4.3MM	6.4	21.2	6.5			
SV1.25-4	#8	4.3MM	7.2	21.2	6.5			
SV1.25-4	#8	4.3MM	8.1	21.2	6.5			
SV1.25-5	#10	5.3MM	8.1	21.2	6.5			
SV1.25-5	#10	5.3MM	9.5	21.2	6.5			
SV1.25-6	1/4	6.5MM	9.5	21.2	6.5			
SV1.25-6	1/4	6.5MM	12.0	21.2	11.0			

Lead section:1.5~2.5mm²(16-14) max current=27A

ITEM.NO.	Number of ANSI bolt	diameter of bolt mouth d2	B (mm)	L (mm)	F (mm)	H (mm)	D φ (mm)	Color
SV-3	#4	3.2MM	5.7	21.2	6.5	10.0	4.9	Blue
SV2-3.5	#6	3.7MM	5.7	21.2	6.5			
SV2-3.5	#6	3.7MM	6.4	21.2	6.5			
SV2-4	#8	4.3MM	6.4	21.2	6.5			
SV2-4	#8	4.3MM	7.2	21.2	6.5			
SV2-4	#8	4.3MM	8.1	21.2	6.5			
SV2-5	#10	5.3MM	8.1	21.2	6.5			
SV2-5	#10	5.3MM	9.5	21.2	6.5			
SV2-6	1/4	6.5MM	9.5	21.2	6.5			
SV2-6	1/4	6.5MM	12.0	12.0	11.0			

Lead section:2.5~4mm²(14~12) max current=37A

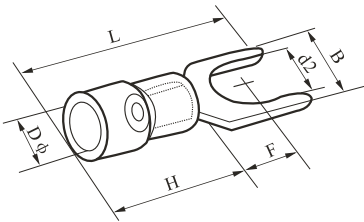

ITEM.NO.	Number of ANSI bolt	diameter of bolt mouth d2 φ	B (mm)	L (mm)	F (mm)	H (mm)	D φ (mm)	Color
SV3.5-4	#8	4.3MM	8.0	24.8	7.0	12.5	6.2	Black
SV3.5-5	#10	5.3MM	8.0	24.8	7.0			
SV3.5-6	1/4	6.5MM	12.0	28.0	12.1			

Lead section:4~6mm²(12~10) max current=48A

ITEM.NO.	Number of ANSI bolt	diameter of bolt Mouth d2	B (mm)	L (mm)	F (mm)	H (mm)	D φ (mm)	color
SV5.5-3.5	#6	3.7MM	8.3	25.2	7.5	12.5	6.7	yellow
SV5.5-4	#8	4.3MM	8.3	25.2	7.5			
SV5.5-4	#8	4.3MM	9.0	23.9	7.5			
SV5.5-5	#10	5.3MM	9.0	23.9	7.5			
SV5.5-6	1/4	6.5MM	9.0	23.9	7.5			
SV5.5-6	1/4	6.5MM	12.0	31.2	12.0			
SV5.5-8	5/16	8.4MM	14.0	30.0	11.5			

MALE INSULATED DISCONNECTORS

Lead section: 0.5~1.5mm²(22~16) max current=10A

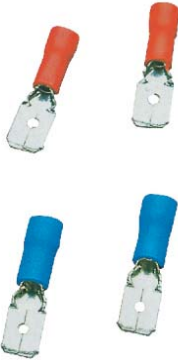

ITEM NO.	Neme tab (mm)	Thickness (mm)	Dimension (mm)				
			B	d φ	D φ	L	H
MDD1.25-110(8)	0.8×2.8	0.8	2.8	1.70	4.3	17.7	10.0
MDD1.25-187(5)	0.5×4.75	0.5	4.75	1.70	4.3	20.0	
MDD1.25-187(8)	0.8×4.75	0.8	4.75	1.70	4.3	18.5	
MDD1.25-250	0.8×6.35	0.4	6.35	1.70	4.3	21.0	



Lead section: 1.5-2.5mm²(16-14) max current=15A

ITEM NO.	Neme tab (mm)	Thickness (mm)	Dimension (mm)				
			B	d φ	D φ	L	H
MDD2-187(5)	0.5×4.75	0.5	4.75	2.3	4.3	20.0	10.0
MDD2-187(8)	0.8×4.75	0.8	4.75	2.3	4.3	18.5	
MDD2-250	0.8×6.35	0.4	6.35	2.3	4.3	21.0	

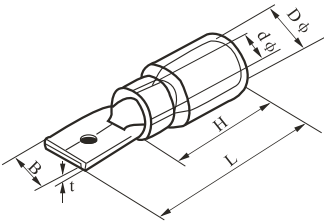

Lead section: 4~6mm²(12~10) max current=24A

ITEM NO.	Neme tab (mm)	Thickness (mm)	Dimension (mm)				
			B	d φ	D φ	L	H
MDD5.5-250	0.8×6.35	0.4	6.35	3.4	5.7	25.0	14.0



Lead section: 4~6mm²(12~10) max current=24A

ITEM NO.	Material	Wire range	Dimension			Thickness
			W	L	E	
DJ6211 -D6.3B	Brass	1.0-1.5	7.7	13.8	7.7	0.35

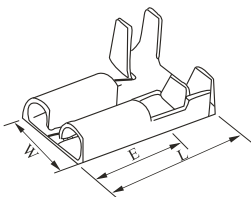

RING INSULATED TERMINALS

Lead section: 0.5~1.5mm²(22-16) max current=19A



ITEM NO.	Number of ANSI bolt	Diameter of bolt Mouth d2 φ	B (mm)	L (mm)	F (mm)	H (mm)	D φ (mm)	Color
RV1.25-3	#4	3.2mm	5.7	17.8	4.95	10.0	4.3	red
RVS1.25-3.5	#6	3.7mm	5.7	17.8	4.95			
RVM1.25-3.5	#6	3.7mm	6.6	20.1	6.3			
RVL1.25-3.5	#6	3.7mm	8.0	21.5	7.0			
RVS1.25-4	#8	4.3mm	6.6	20.1	6.3			
RVL1.25-4	#8	4.3mm	8.0	21.5	7.0			
RV1.25-5	#10	5.3mm	8.0	21.5	7.0			
RV1.25-6	1/4	6.5mm	11.6	27.5	11.1			
RV1.25-8	5/16	8.4mm	11.6	27.5	11.1			
RV1.25-10	3/8	10.5mm	13.6	31.6	13.9			

Lead section: 1.5,-2.5mm²(16~14) max current=27A



ITEM NO.	Number of ANSI bolt	Diameter of bolt Mouth d2 φ	B (mm)	L (mm)	F (mm)	H (mm)	D φ (mm)	Color
RV2-3	#4	3.2mm	6.6	17.8	4.3	10.0	4.9	blue
RVS2-3.5	#6	3.7mm	6.6	17.8	4.3			
RVM2-3.5	#6	3.7mm	6.6	21.0	7.0			
RVL2-3.5	#6	3.7mm	8.5	22.5	7.75			
RVS2-4	#8	4.3mm	6.6	21.0	7.0			
RVL2-4	#8	4.3mm	8.5	22.5	7.75			
RVS2-5	#10	5.3mm	8.5	22.5	7.75			
RVL2-5	#10	5.3mm	9.5	22.5	7.25			
RV2-6	1/4	6.5mm	12.0	27.6	11.0			
RV2-8	5/16	8.4mm	12.0	27.6	11.0			
RV2-8	3/8	10.5mm	13.6	30.2	13.9			

Lead section: 2.5~4mm²(14~12) max current=37A

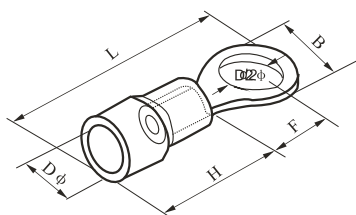

ITEM NO	Number of ANSI bolt	Diameter of bolt mouth d2 φ	B (mm)	L (mm)	F (mm)	H (mm)	D φ (mm)	Color
RV3.5-4	#8	4.3mm	8.0	24.5	7.7	12.5	6.2	black
RVS3.5-5	#10	5.3mm	8.0	24.5	7.7			
RVL3.5-5	#10	5.3mm	12.0	27.9	7.7			
RV3.5-6	1/4	6.5mm	12.0	27.9	7.7			

Lead section: 4-6mm²(12-10) max current=48A

ITEM NO.	Number of ANSI bolt	Diameter of bolt Mouth d2 φ	B (mm)	L (mm)	F (mm)	H (mm)	D φ (mm)	Color
RV5.5-3.5	#6	3.7mm	7.2	21.4	5.9	12.5	6.7	Yellow
RVS5.5-4	#8	4.3mm	7.2	21.5	5.9			
RVL5.5-4	#8	4.3mm	9.5	25.5	8.3			
RV5.5-5	#10	5.3mm	9.5	25.5	8.3			
RV5.5-6	1/4	6.5mm	12.0	31.5	13.0			
RV5.5-8	5/16	8.4mm	15.0	33.7	13.7			
RV5.5-10	3/8	10.5mm	15.0	33.7	13.7			
RV5.5-12	1/2	13.0mm	19.2	38.1	16.0			

BUTT INSULATED

Insulated butt connectors

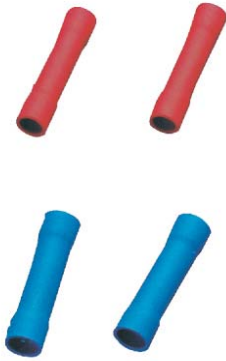

ITEM NO.	AWG	mm ²	Dimension (mm)			Max	Color
			I	D φ	L		
BV1.25	22~16	0.5~1.5	15.0	1.7	26.0	19A	Red
BV2	16~14	1.5~2.5	15.0	2.3	26.0	27A	Blue
BV5.5	12~10	4~6	15.0	3.4	26.0	48A	Yellow
BV8	#8	6~10	21.0	4.5	32.0	62A	Red
BV14	#6	10~16	26.0	5.8	42.0	88A	Blue
BV22	#4	16~25	29.0	7.7	50.0	115A	Yellow
BV38	#2	35~50	32.0	9.4	55.0	160A	Red

Insulated butt connectors



ITEM NO.	AWG	mm ²	Dimension (mm)			Max	Color
			I	D φ	L		
PVT1.25	22~16	0.5~1.5	8.0	1.7	16.0	19A	Red
PVT2	16~14	1.5~2.5	8.0	2.3	16.0	27A	Blue
PVT5.5	12~10	4~6	8.5	3.4	20.5	48A	Yellow



Insulated butt connectors

ITEM NO.	Dimension			Wire range		
	I (mm)	D φ (mm)	D φ (mm)	Single mm	Twin mm ²	A.W.G
B-1.25	16.5	3.3	1.9	0.57~1.44	0.25~1.65	22~16
B-2	16.5	4.0	2.6	1.44~1.82	1.04~2.63	16~14
B-5.5	16.5	5.5	3.7	1.82~2.89	2.63~6.64	12~10
B-8	22.5	7.1	5.1	2.89~3.65	6.4~10.52	8
B-14	27.5	9.0	6.4	3.65~4.62	10.52~16.78	6
B-22	30.5	11.4	8.2	4.62~5.81	16.78~26.66	4
B-38	33.5	13.3	10.1	5.81~7.34	26.66~42.42	2
B-60	36.0	15.4	12.0	7.34~8.26	42.42~60.57	1/0
B-70	37.8	17.4	14.0	8.26~9.27	60.57~76.28	2/0
B-80	39.5	19.4	15.4	9.27~10.41	76.28~96.3	3/0
B-100	39.5	22.0	17.6	10.41~11.68	96.6~117.2	4/0
B-125	43.4	24.1	19.2	10.01~12.7	107.2~130.4	4/0
B-150	55.5	26.0	20.9	11.68~13.8	117~152.05	250~300MCM
B-180	58.5	28.6	22.0	13.8~15.6	152.05~192.6	300~350MCM
B-200	64.5	32.5	25.7	15.6~17.5	192.6~242.2	400MCM
B-250	64.5	32.5	25.7	15.6~17.5	192.6~242.2	400MCM
B-325	73.5	37.0	29.0	17.5~20.3	242.2~325	500~600MCM

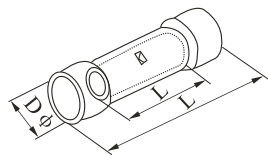

BUTT INSULATED CONNECTORS

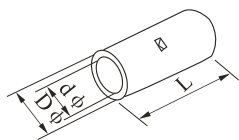

BUTT CONNECTORS

BULLET & RECEPTACLE INSULATED DISCONNECTORS

Lead section: 0.5~1.5mm²(22~16) max current=10A



ITEM NO.	Thickness (mm)	Dimension						Color
		b φ (mm)	F (mm)	D φ (mm)	d φ (mm)	H (mm)	L (mm)	
MPD1.25-156	0.4	4.0	11.0	2.7	1.7	10.0	21.0	Red

Lead section: 1.5~2.5mm²(16~14) max current=15A



ITEM NO.	Thickness (mm)	Dimension						Color
		b φ (mm)	F (mm)	D φ (mm)	d φ (mm)	H (mm)	L (mm)	
MPD2-156	0.4	4.0	16.0	2.7	1.7	10.0	21.0	Blue
MPD2-195	0.4	5.0	16.0	2.7	1.7	10.0	21.0	

Lead section: 4~6mm²(12~10) max current=24A



ITEM NO.	Thickness (mm)	Dimension						Color
		b φ (mm)	F (mm)	D φ (mm)	d φ (mm)	H (mm)	L (mm)	
MPD5.5-195	0.4	4.0	11.0	4.5	3.4	14.0	25.0	Yellow

Lead section: 0.5~1.5mm²(22~16) max current=10A

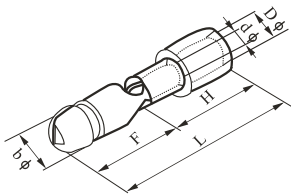

MALE

ITEM NO.	Thickness (mm)	Dimension						Color
		b φ (mm)	F (mm)	D φ (mm)	d φ (mm)	H (mm)	L (mm)	
FRD1.25-156	0.4	5.4	16.0	2.7	1.7	13.0	24.5	Red

Lead section: 1.5~2.5mm²(16~14) max current=15A

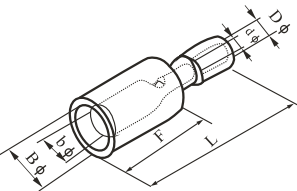

FEMALE

ITEM NO.	Thickness (mm)	Dimension						Color
		B φ (mm)	F (mm)	D φ (mm)	d φ (mm)	H (mm)	L (mm)	
FRD1.25-156	0.4	4.0	6.3	3.3	2.3	14.0	24.5	Blue
FRD1.25-195	0.4	5.0	7.0	3.3	2.3	14.0	24.5	

Lead section: 4~6mm²(12~10) max current=24A

ITEM NO.	Thickness (mm)	Dimension						Color
		B φ (mm)	F (mm)	D φ (mm)	d φ (mm)	H (mm)	L (mm)	
FRD5.5-195	0.4	5.0	7.0	4.5	2.4	14.0	29.5	Yellow

FULLY VINYL INSULATED DISCONNECTORS

Lead section: $0.5 \sim 1.5 \text{mm}^2$ (22~16) max current=10A

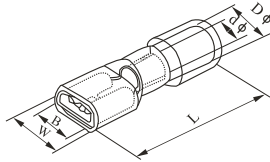

ITEM NO.	Neme tab (mm)	Dimension				
		W (mm)	B (mm)	D φ (mm)	d φ (mm)	L (mm)
FDFD1.25-187(5)	0.5×4.75	5.6	3.28	4.0	1.7	20.0
FDFD1.25-187(8)	0.8×4.75	5.6	3.28	4.0	1.7	20.0
FDFD1.25-250	0.8×6.35	7.4	3.28	4.0	1.7	21.5

Lead section: $1.5 \sim 2.5 \text{mm}^2$ (16~14) max current=15A

ITEM NO.	Neme tab (mm)	Dimension				
		W (mm)	B (mm)	D φ (mm)	d φ (mm)	L (mm)
FDFD2-187(5)	0.5×4.75	5.6	5.0	4.5	2.3	20.0
FDFD2-187(8)	0.8×4.75	5.6	5.0	4.5	2.3	20.0
FDFD2-250	0.8×6.35	7.4	5.0	4.5	2.3	21.5

Lead section: $4 \sim 6 \text{mm}^2$ (12~10) max current=24A

ITEM NO.	Neme tab (mm)	Dimension				
		W (mm)	B (mm)	D φ (mm)	d φ (mm)	L (mm)
FDFD5.5-250	0.8×6.35	7.4	6.6	5.7	3.4	25.5

PIGGY BACK DISCONNECTORS

Lead section: $0.5 \sim 1.5 \text{mm}^2$ (22~16) max current=10A

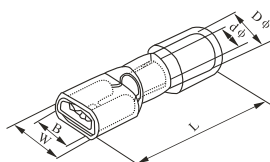

ITEM NO.	Neme tab (mm)	Dimension					
		B (mm)	B1 (mm)	B (mm)	D φ (mm)	d φ (mm)	L (mm)
PBDD1.25-250	0.8×6.35	7.4	6.3	10.0	3.8	1.7	21.5

Lead section: $0.5 \sim 1.5 \text{mm}^2$ (22~16) max current=10A

ITEM NO.	Neme tab (mm)	Dimension					
		B (mm)	B1 (mm)	B (mm)	D φ (mm)	d φ (mm)	L (mm)
PBDD2-250	0.8×6.35	7.4	6.3	10.0	4.3	2.3	21.5

Lead section: $4 \sim 6 \text{mm}^2$ (12~10) max current=24A

ITEM NO.	Neme tab (mm)	Dimension					
		B (mm)	B1 (mm)	B (mm)	D φ (mm)	d φ (mm)	L (mm)
PBDD5.5-250	0.8×6.35	7.4	6.3	14.0	5.7	3.4	25.0

INSULATED CORD END TERMINALS

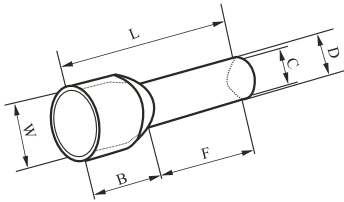
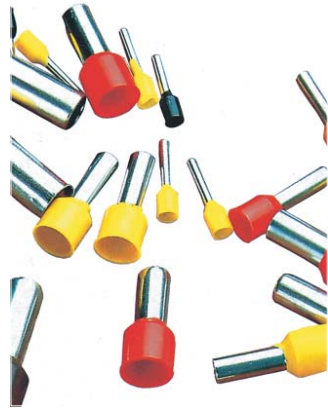

ITEM No .	Dimension						A.W.G	mm ²	Insulation color
	F (mm)	L (mm)	W (mm)	B (mm)	D (mm)	C (mm)			
E0506	6.0	12.0	2.6	6.0	1.3	1.0	#22	0.5	orange white
E0508	8.0	14.0							
E0510	10.0	16.0							
E0512	12.0	18.0							
E7506	6.0	12.4	2.8	6.4	1.5	1.2	#20	0.75	white blue
E7508	8.0	14.6							
E7510	10.0	16.4							
E7512	12.0	18.4							
E7518	18.0	24.4							
E1006	6.0	12.4	3.0	6.4	1.7	1.4	#18	1.0	yellow red
E1008	8.0	14.6							
E1010	10.0	16.4							
E1012	12.0	18.4							
E1508	8.0	14.6	3.5	6.4	2.0	1.7	#16	1.5	red blue
E1510	10.0	16.4							
E1518	18.0	24.4							
E2508	8.0	15.2	4.0	7.5	2.6	2.3	#14	2.5	blue grey
E2512	12.0	19.0							
E2518	18.0	25.0							
E4009	9.0	16.5	4.4	7.5	3.2	2.8	#12	4.0	grey orange
E4012	12.0	19.5							
E4018	18.0	25.5							
E6012	12.0	20.0	6.3	8.0	3.9	3.5	#10	6.3	black green
E6018	18.0	26.0							
E10-12	12.0	21.5	7.6	9.5	4.9	4.5	#7	10.0	milky white brown green
E10-18	18.0	27.5							
E16-12	12.0	22.0	8.8	10.2	6.2	5.8	#5	16.0	green milky white
E16-18	18.0	28.2							
E25-16	16.0	29.0	11.2	13.0	7.9	7.5	#4	25.0	brown green black
E25-22	22.0	35.0							
E35-16	16.0	30.0	12.7	14.0	8.7	8.3	#2	35.0	greyish brown
E35-25	25.0	39.0							
E50-20	20.0	36.0	15.3	16.0	10.9	10.3	#1	50.0	Oilve
E50-25	25.0	41.0							

INSULATED RING TERMINALS

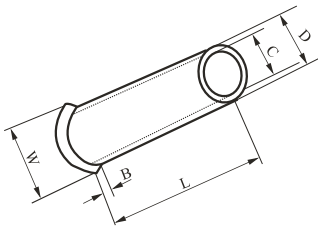

ITEM NO.	Dimension					A.W.G	mm ²
	L (mm)	D (mm)	C (mm)	B (mm)	W (mm)		
EN0506	6.0	1.3	1.0	0.7	2.1	#22	0.5
EN75.6	6.0	1.5	1.2	0.7	2.5	#20	0.75
EN1006	6.0	1.7	1.4	0.7	2.7	#18	1.0
EN1010	10.0						
EN1507	7.0	2.0	1.7	1.0	3.5	#16	1.5
EN1510	10.0						
EN2507	7.0	2.5	2.2	1.0	2.5	#14	2.5
EN2512	12.0						
EN4009	9.0	3.2	2.8	1.0	4.0	#12	4.0
EN4012	12.0						
EN6010	10.0	3.9	3.5	1.0	4.8	#10	6.0
EN6012	12.0						
EN6015	15.0						
EN10-12	12.0	4.9	4.5	1.2	5.8	#7	10.0
EN10-15	15.0						
EN10-18	18.0						
EN16-12	12.0	6.2	5.8	1.5	7.5	#5	16.0
EN16-15	15.0						
EN16-18	18.0						
EN25-16	16.0	7.9	7.5	1.8	9.2	#4	25
EN25-22	22.0						
EN35-16	16.0	8.7	8.3	2.0	10	#2	35
EN35-25	25.0						
EN50-20	20.0	10.9	1.3	2.0	12.4	#1	50
EN50-25	25.0						

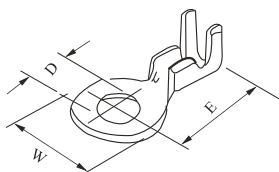

Y type

ITEM NO .	Material	wire range	Dimension			Thickness
			D	W	E	
Y3-2.5	Brass	0.5-2.5	3.2			0.6
DJ431-3A		0.5-0.8	3.5	9.0	17.0	0.5
DJ431-5A		0.5-0.8	5.2	10.0	17.0	0.5
DJ431-6A		0.5-0.8	6.2	12.0	17.0	0.5
DJ431-8B		1.0-1.5	8.2	15.0	17.0	0.8
DJ431-10B		1.0-1.5	10.5	19.0	19.0	0.8